

**NOTE:**

1. Electrical test:
  - (1). 100% open short & miss wire test;
  - (2). Insulation resistance: DC 300V/5s 10M Ω min;
  - (3). Contactor resistance: 3 Ω max
2. RoHS compliant.

**PIN OUT**

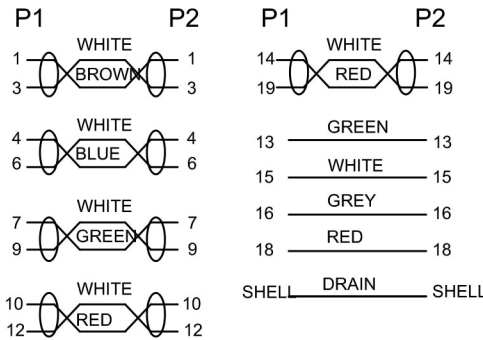

**PACKING DRAW**

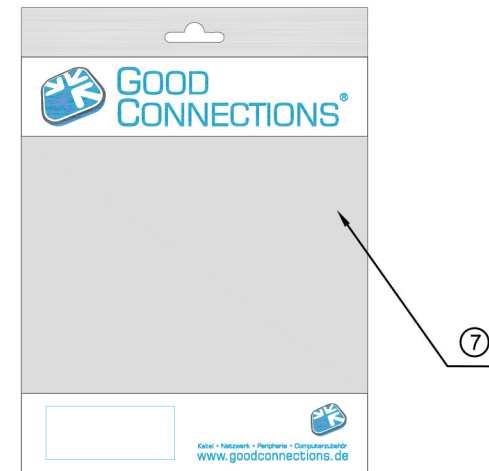

**MATERIAL LIST**

⑦	PACKAGE	GOOD CONNECTIONS ZIP BAG	1
⑥	DUST COVER	PE, COLOR: TRANSPARENT	2
⑤	PRINTING	Good Connections High Speed HDMI® CABLE WITH ETHERNET E258105 AWM STYLE 20276 80°C 30V VW-1	
④	CABLE	(1/0.25 CCS*1P+WAM)*5PCS+1/0.25 CCS*4C+AL+1/0.25 CCS+PVC, OD: 5.0±0.1mm, COLOR: BLACK	L
③	OUTER MOLD	PVC 88A, COLOR: BLACK	2
②	INNER MOLD	LD-PE	2
①	CONNECTOR	HDMI 19PIN A MALE, GOLD PLATED PIN, GOLD PLATED SHELL	1
No.	PART NAME	DESCRIPTION	QTY

**alcasa elektronik ag**  
Ihr Spezialdistributor für Kabel, Netzwerk, Peripherie und Zubehör

DRAW No.		NAME	HDMI CABLE, 1080P	
CUSTOMER		MAPE	TOLERANCE	
MODEL No.	4514 SERIES		X.	±1.00
APPROVE BY	CHECK BY	DATE	SCALE	MM
FL	GR	22.09.2015	PAGE	1/1